

VACUUM BREAKER VB16

DESCRIPTION

The VB16 vacuum breakers are simple and reliable devices that automatically relieve or "break" an unwanted vacuum condition, restoring the atmospheric pressure.

This device is particularly suitable for steam heated units of small and medium volume, such as heat exchangers, heating coils, calorifiers, jacketed kettles, steam boilers, etc.

Connections are male screwed.

OPTIONS:	Stainless steel inlet deflector.
USE:	Saturated steam and other gases compatible with the construction.
AVAILABLE MODELS:	VB16.
SIZES:	1/2" to 1".
SET PRESSURE RANGES:	0,05 – 0,10 bar; 0,09 – 0,20 bar; 0,19 – 0,30 bar; 0,29 – 0,40 bar; 0,39 – 0,50 bar.
CONNECTIONS:	Screwed ISO 7/1 RP (BS21).
INSTALLATION:	Vertical installation. See IMI – Installation and maintenance instructions.
LIMITING CONDITIONS:	12 bar at 150 °C. 16 bar at 120 °C.

How to order: i.e. VB16 1/2" BSP (0,05 – 0,10bar).



Überreicht durch:
ASA Horst Wieber GmbH, Werner-von-Siemens-Str. 17, 28816 Stuhr
Tel.: 0421/565727-0 • E-Mail: info@asa-germany.de • www.asa-germany.de

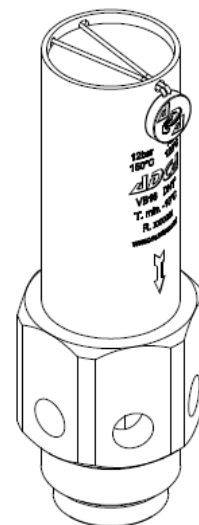
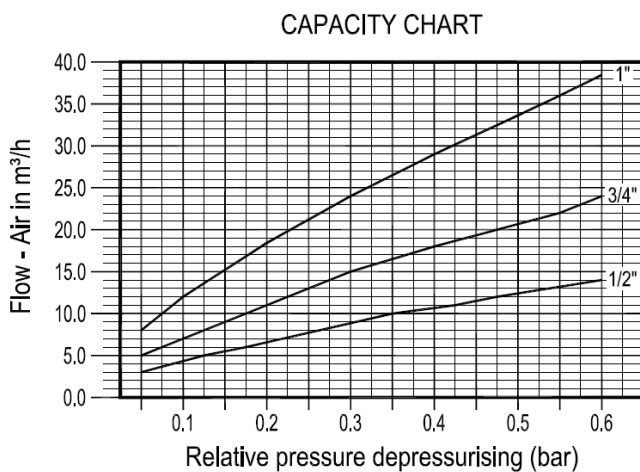

DIMENSIONS (mm)

SIZE	A	B	C	D	E	F	G	SW	WGT. (kg)
1/2"	26	82	11	35	18	12,5	23	32	0,25
3/4"	33	85	13	39	21	16,5	28	36	0,34
1"	33	108	15	45	27,5	20	35	41	0,51

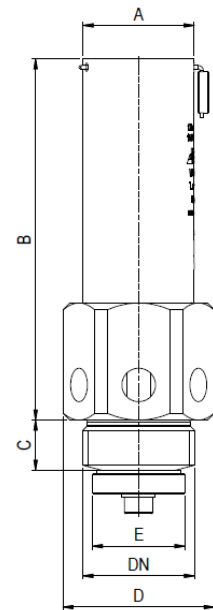
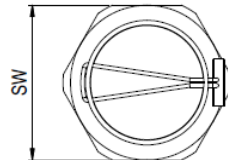

MATERIALS

POS. Nº	DESIGNATION	MATERIAL
1	Body	AISI 316 / 1.4401
2	* Valve	AISI 316 / 1.4401 ; Viton
3	Stem	AISI 304 / 1.4301
4	* Spring	AISI 302 / 1.4300
5	Spring guide	AISI 304 / 1.4301
6	Nut	A2-70

* Available spare parts;

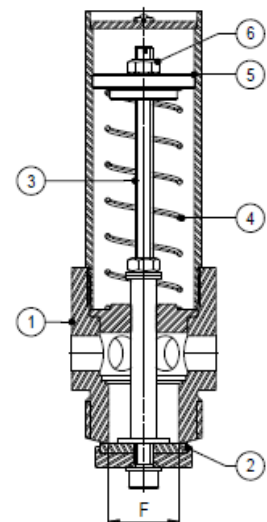

TYPICAL INSTALLATION

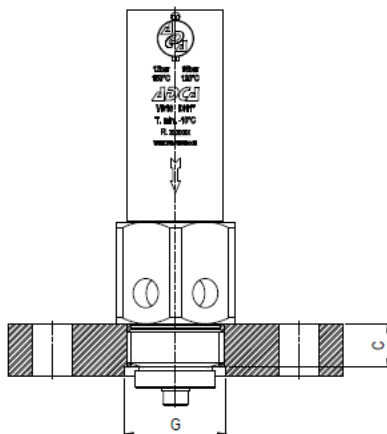

With flange

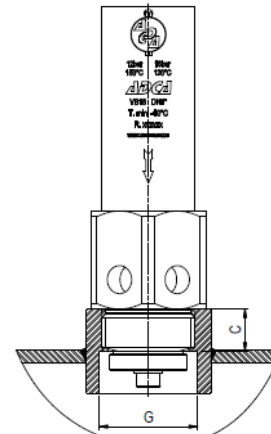

With socket